

VAPORA 3672

72" x 36" x 20 3/4"



PRODUCT DESCRIPTION:

Adjustable feet
Transitional style
Gloss finish resistant to stains and discoloration
Acrylic thermoformed and reinforced with fiberglass

5 days

WATER CAPACITY:

78 gallons

IMMERSION:

15 1/4 po

BOX SIZE:

72 1/2" x 36 1/2" x 24"

NET WEIGHT:

102 lbs

GROSS WEIGHT:

121 lbs

GENERAL OPTIONS

Acrylic Colors: White	Standard
Biscuit* and Bone* (Allow 3 weeks delivery)	Standard
Others*: (Allow 6 to 8 weeks delivery)	
Chromotherapy 1 light (Specify trim color)	17.99999.0000.00
Chromotherapy 2 lights (Specify trim color)	17.99999.0001.00
Chromotherapy 4 lights (Specify trim color)	17.99999.0002.00
Handle (max. 2) (submit drawing with order)	95.7077.106.XX
D105 Waste (20") Chrome	62.4020.102.60
Gel black neck pillow (12"x 4 1/4 x 1 1/4")	18.6000.100.20
Rayola** (Specify control color)	

WHIRLPOOL OPTIONS

A bathtub fitted with back jets may cause the pump to protrude by +/- 3" from the overall dimension.

Pump is located behind seat

Whirlpool Jet finish: Chrome, White, Biscuit, Bone Standard

110v Inline Heater (1)

Ozonator

TurboAir (1)

MASS-AIR/ACTIV-AIR OPTIONS

Mass-Air Jet finish: White/Chrome Standard
Biscuit/Chrome
Bone/Chrome

Others: Chrome/Chrome

Activ-Air Jet finish: Chrome, White, Biscuit, Bone Standard

Blower Hose extension 36" 95.5013.116.00

Blower Hose extension 72" 95.5013.167.00

Blower Hose extension 96" 95.5013.168.00

144" Extension cord 95.3012.101.00

An extension cord and blower hose extension are necessary when the blower is located more than 2' from the electronic control, not available on whirlpool combos.

TONIC OPTIONS

Waste included for bathtub with Tonic system: Chrome

Tonic Jet finish: White, Biscuit, Bone, Chrome Standard

*Customized products, non cancellable, non returnable.

**Not available with a neck pillow.

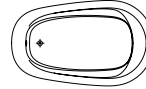

Bathtub only

VA3672

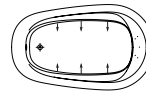

Whirlpool

VA3672T

Included: 6 turbo jets, 5 micro-rotating back jets, 13 A pump, one diverter valve and electronic control.

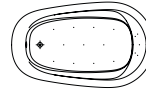

Mass-Air

VA3672M

Included: 16 (11-5) injectors, Optima blower 750W (1 1/2 h.p.) with 300W heating element and backlit electronic control.

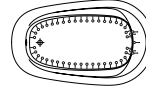

Activ-Air

VA3672A

Included: 49 micro-jets, Optima blower 750W (1 1/2 h.p.) with 300W heating element and backlit electronic control.

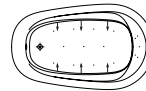

Mass-Air/Whirlpool Combo

VA3672C

Included: 6 turbo jets, 5 micro-rotating back jets, 11 Mass-Air injectors, 13 A pump, Optima blower 750W (1 1/2 h.p.) with 300W heating element, one diverter valve and backlit electronic control.

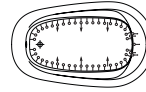

Activ-Air/Whirlpool Combo

VA3672CA

Included: 6 turbo jets, 5 micro-rotating back jets, 44 Activ-Air micro-jets, 13 A pump, Optima blower 750W (1 1/2 h.p.) with 300W heating element, one diverter valve and backlit electronic control.

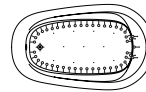

Mass-Air/Activ-Air Combo

VA3672CMA

Included: 49 Activ-Air micro-jets, 11 Mass-Air injectors, two Optima blowers 750W (1 1/2 h.p.) with 300W heating element and backlit electronic control.

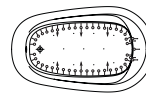

Activ-Air/Mass-Air/Whirlpool Combo

VA3672TAM

Included: 6 turbo jets, 5 micro-rotating back jets, 44 Activ-Air micro-jets, 11 Mass-Air injectors, 13 A pump, two Optima blowers 750W (1 1/2 h.p.) with 300W heating element, one diverter valve and backlit electronic control.

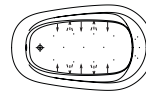

Tonic

VA3672Q

Included: 8 Oxygen jets, Optima blower 750W (1 1/2 h.p.) with 300W heating element, Syllent pump with integrated in-line heater, 4 Chromotherapy lights and backlit tactile electronic control.



Intertek

COMPLIANCE ATTESTATION
Standard bathtubs
CAN / CSA.B45.5
Hydromassage Standards
CAN / CSA.B45.10 / CSA.C22.2 / UL-1795



Certification ECORESPONSIBLE
First manufacturer of bathroom products in North America to be certified ecoresponsible.



Produits Neptune
6835, Picard street, Saint-Hyacinthe (Quebec) J2S 1H3
Phone: (450) 773-7058 - Fax: (450) 773-5063
produitsneptune.com



Produits Neptune

VAPORA 3672

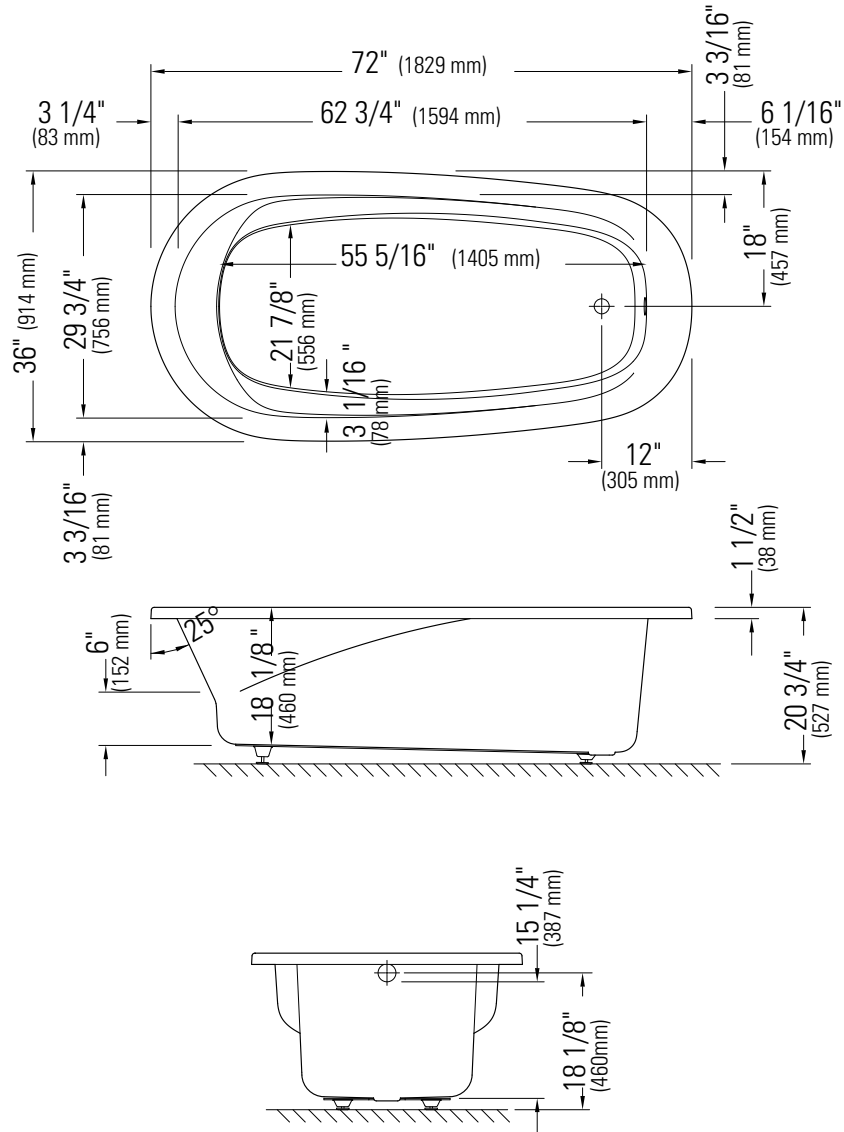

*A bathtub fitted with back jets can cause the pump to protrude by approximately 3" from the overall dimension.

**All dimensions are approximate and subject to change without notice. Please refer to the installation guide before beginning the installation